

# BATTLESTAR GALACTICA

## COLONIAL WARRIOR BLASTER



### **Zealot** Model of the Month - May 2012

This cardmodel is free. It is a non-profit fan project and for personal use only. No commercial use.

Battlestar Galactica ©, (R) and TM Universal City Studios / SyFy Channel. No infringement intended.

This paper model is available in a coloured (standard) version and a white (Ship-of-Lights / timetravel) version. The parts pages have been sorted so that you can print several pages in black and white only to save ink. For best results it is recommended to print in full colour though. You may use the white model parts to print on coloured cardboard to save ink, too. All parts which have to be laminated to cardboard are arranged on one page.

Special thanks to Chris "Rhaven Blaack" Tucker for test-building and advice and to the members at [zealot.com](http://zealot.com) for their support, patience and encouragement!

Please post pictures of your builds on [www.zealot.com](http://www.zealot.com) or send them to [gal78@hotmail.de](mailto:gal78@hotmail.de) (please refer to "model pics" or your mail will be regarded as spam).

Have fun and enjoy!



5/2012

## Important:

- Do NOT cut out white areas which are NOT marked with an **x**. These areas were uncoloured to save ink while printing and will be covered by detail parts.
  - Many parts come with very small or no glue tabs. Work carefully and take your time.
  - It is not necessary to cut off the flaps and glue the parts from behind.
  - Parts page 10 is optional and has to be printed only if you would like to (or have to) build a black muzzle. There are optional parts for lighting available. Please refer to page 13.
- **!** = difficult = work very carefully      - **x** = cut out

## Muzzle

Tape the transparent muzzle parts page behind clear sheet and trace all folding lines with the sharp edge of your cutter / knife / scalpel. Scratch only the upper surface of the sheet. Apply pressure VERY GENTLY to avoid cutting through. You may have to practise the procedure on a piece of scrap sheet first.

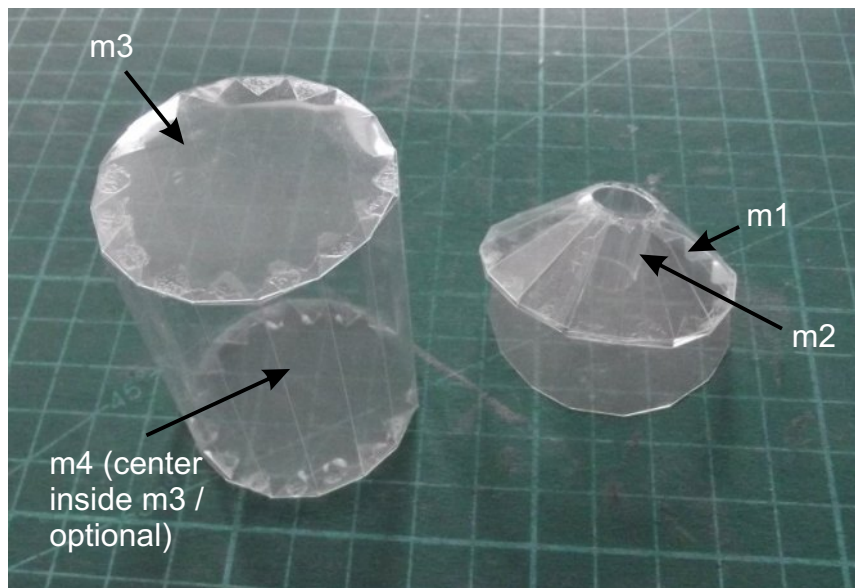

Then cut out the parts and gently fold them into position. Be careful because some sheets may break easily. The red areas are glue tabs. Use universal glue to glue the parts together. The use of tape and water-based glue is not recommended because it leads to a sloppy result (and could ruin your day ;-) !).

If you are having difficulty cutting / glueing the transparent sheet print out the coloured parts page and make a black muzzle.

Fold and glue part m3a to the bottom with the blue laser emitter facing the inside of the muzzle (not necessary if you do not use clear parts).

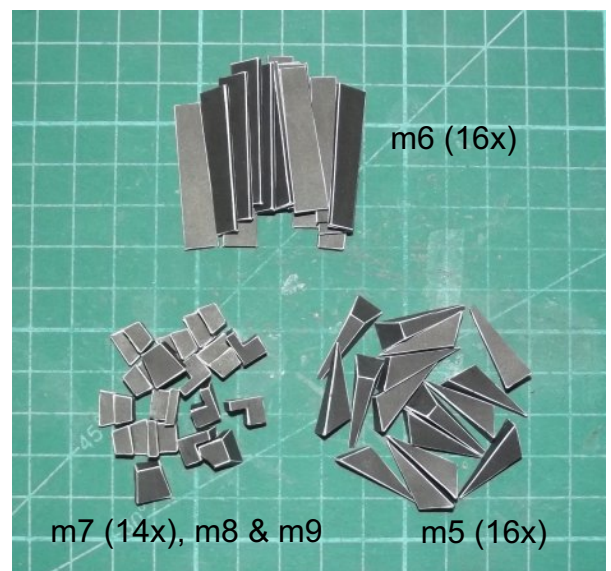
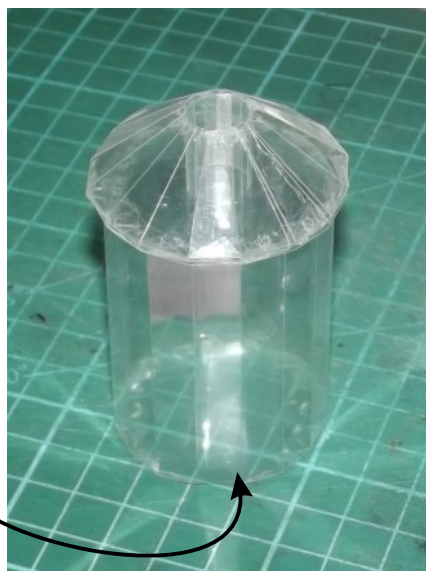



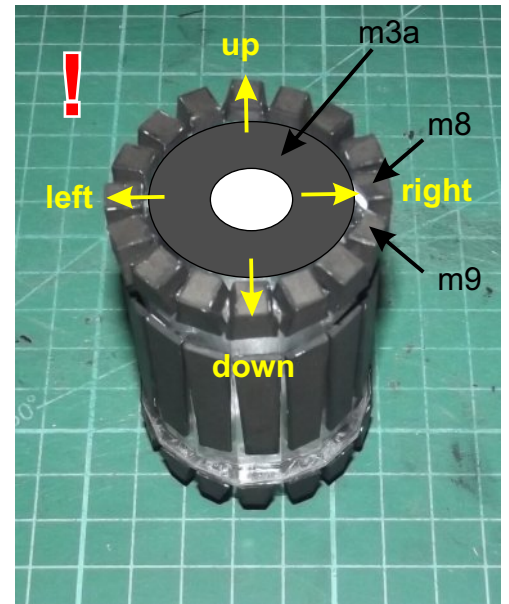

## Handle

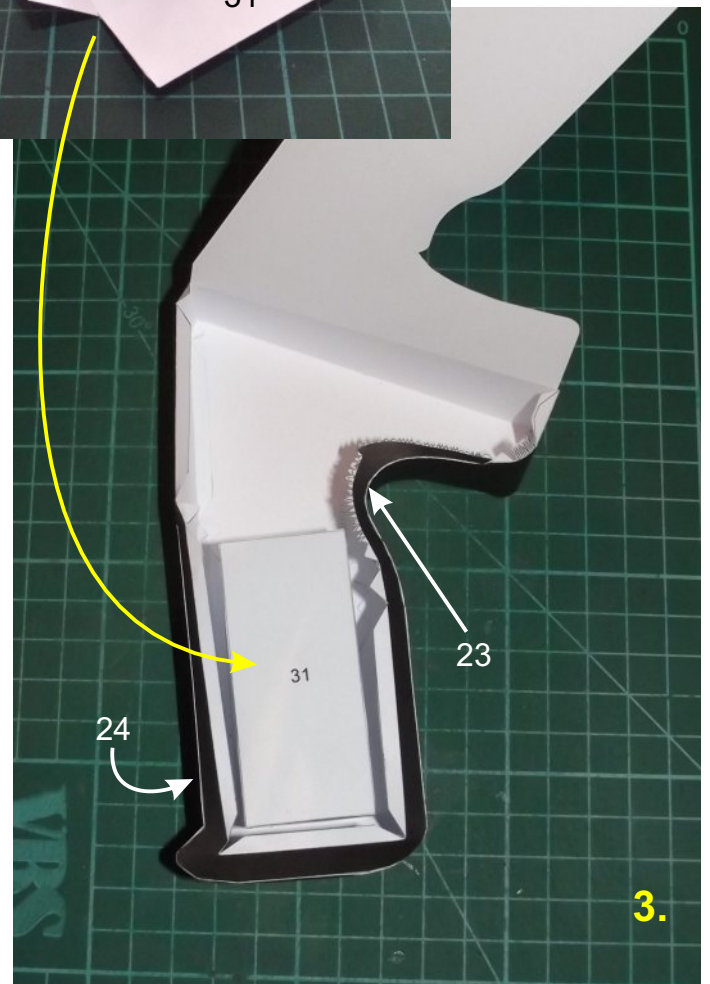
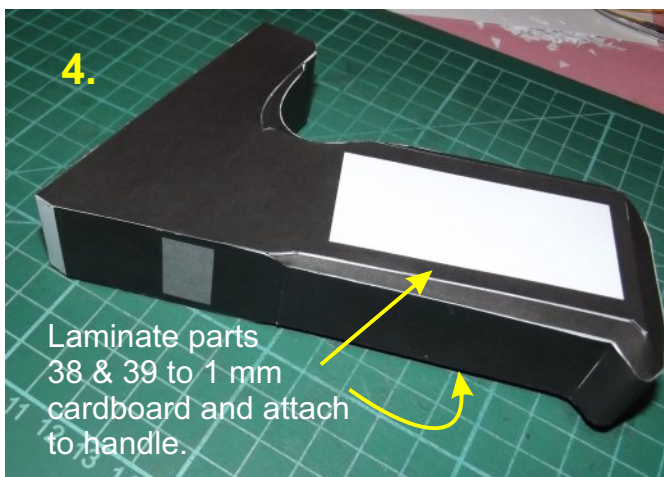
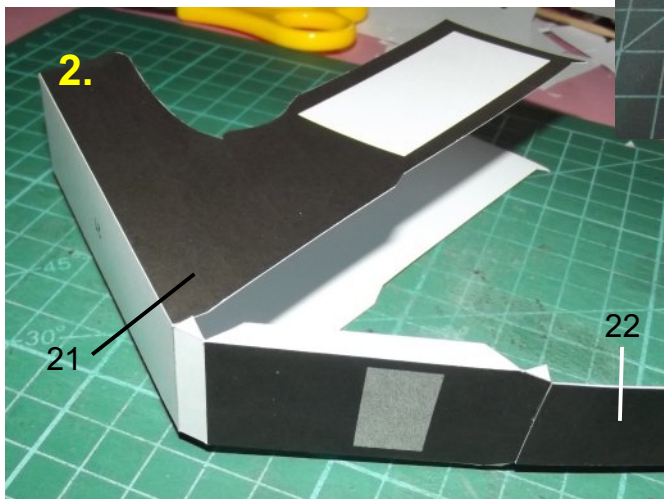
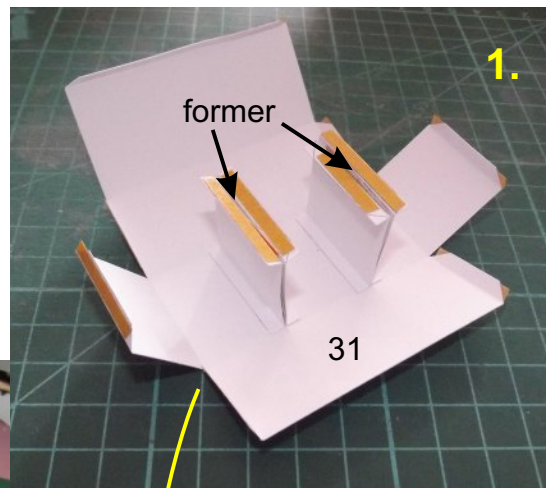

# Main Block

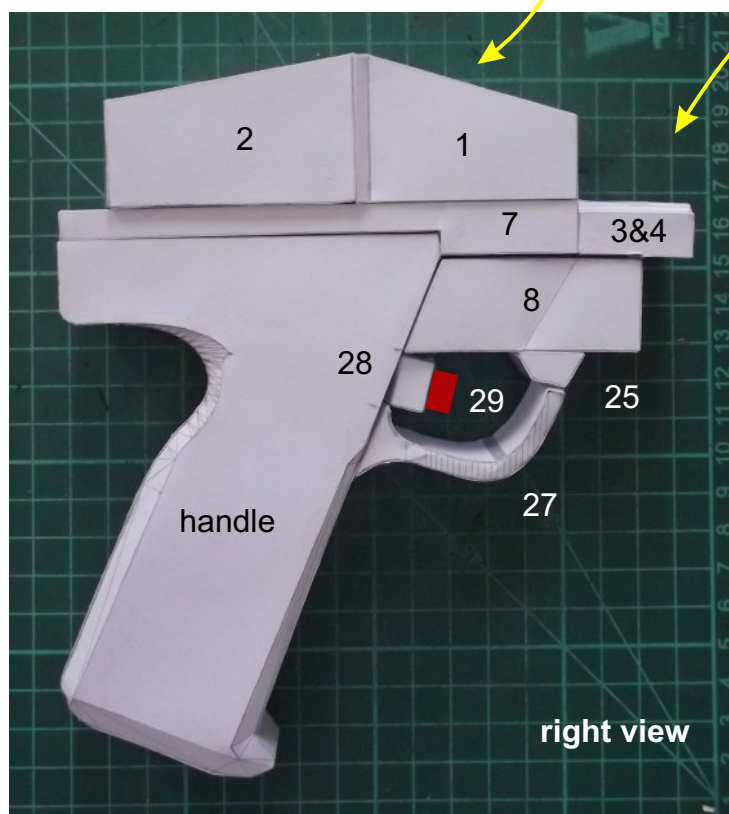
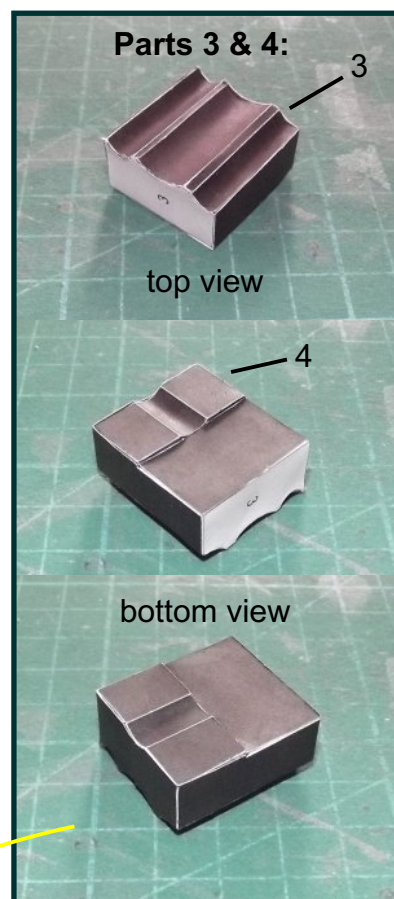
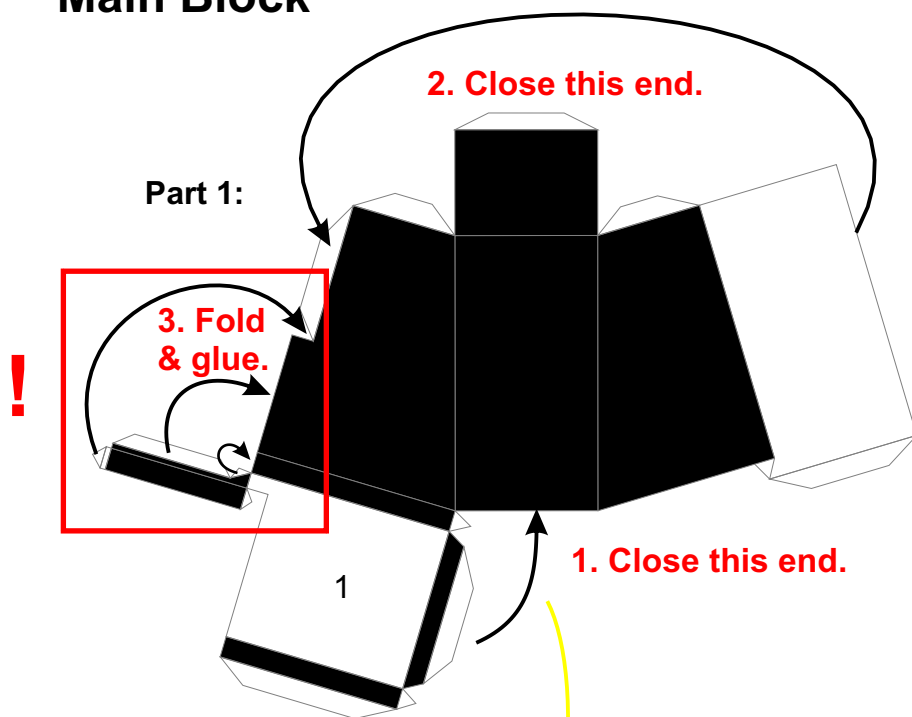



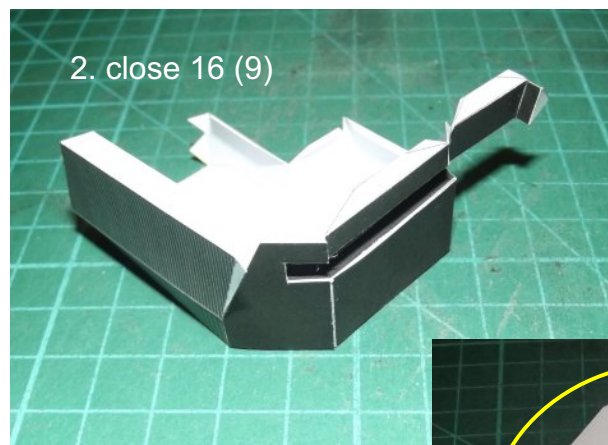
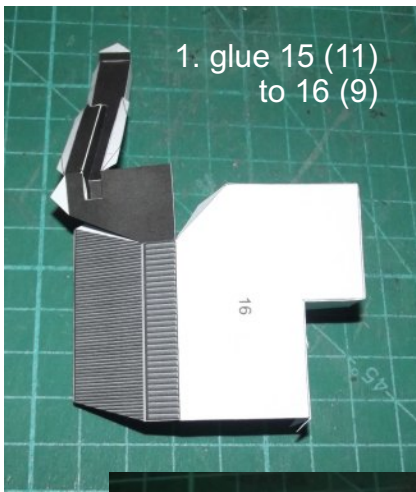
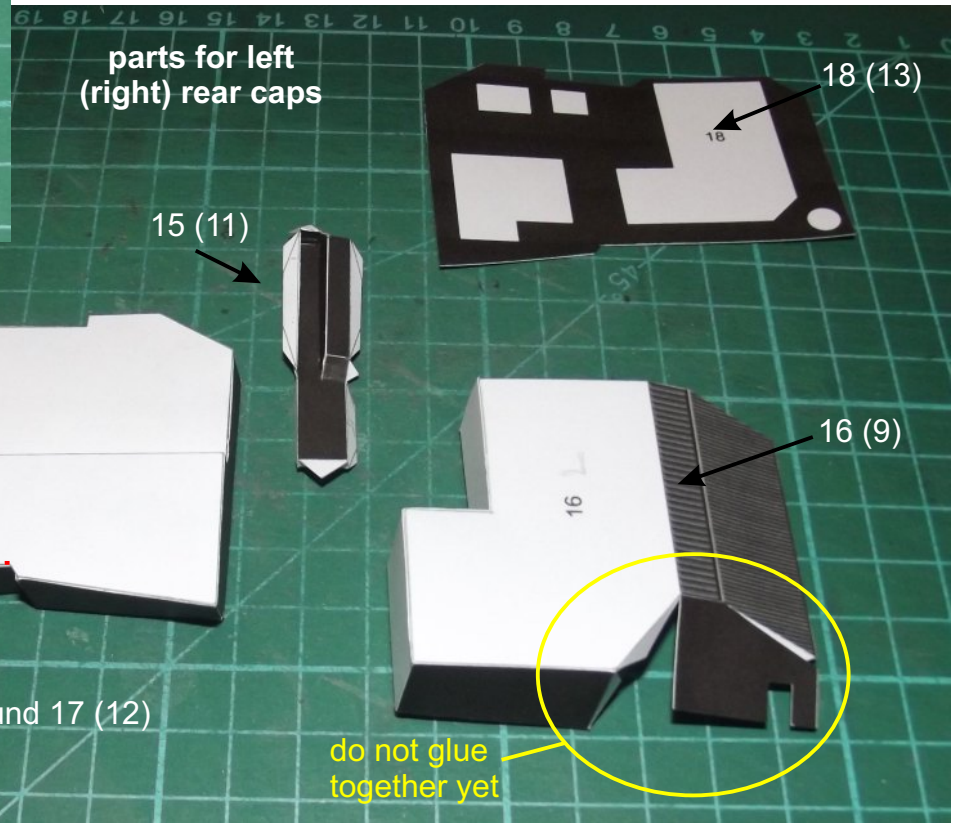

**Caps !!!**





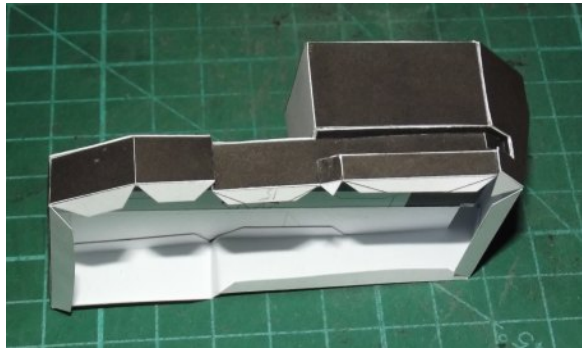

**NOTE:**

The white markings on 13 & 18 indicate the approximate position of the greeblies. They are slightly smaller to ensure that they are completely covered by the parts.

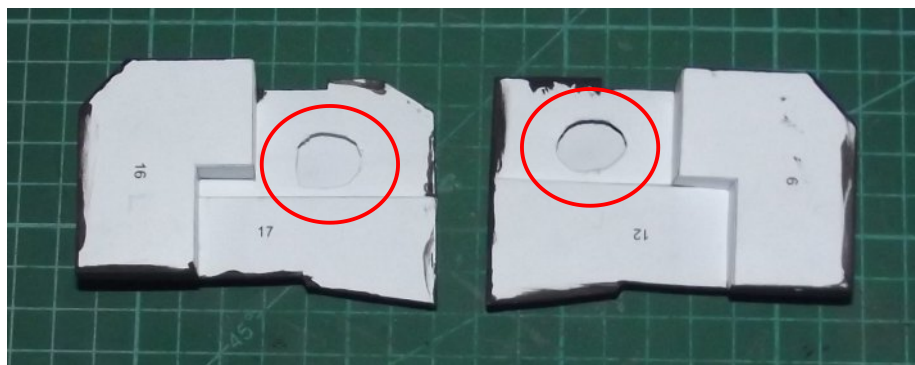
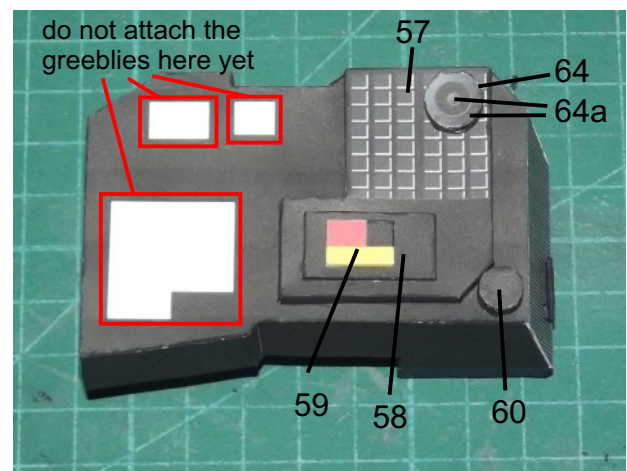
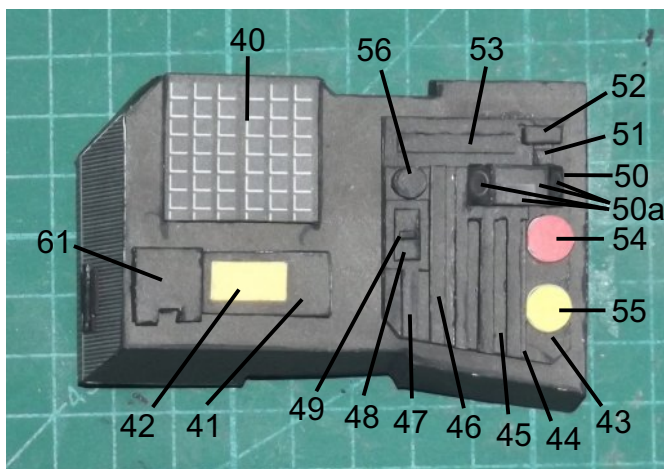
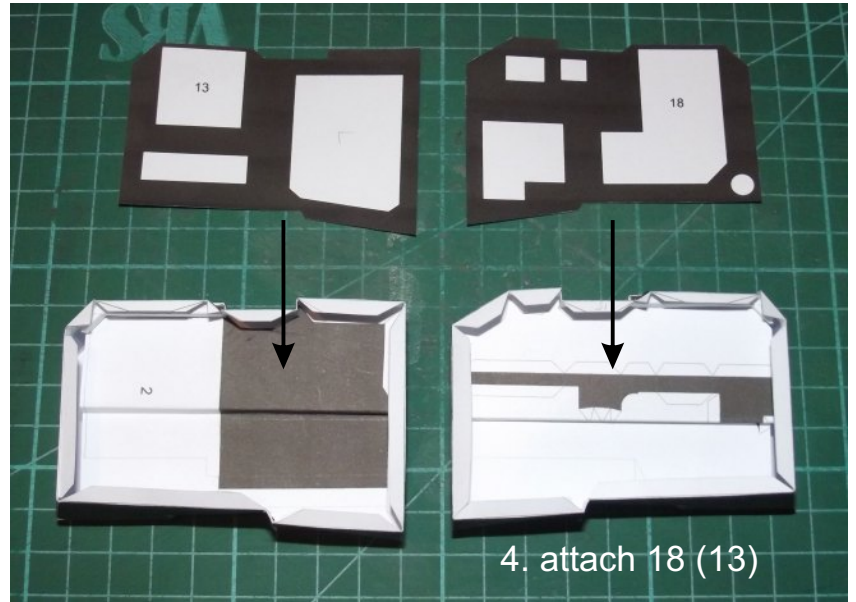

**QUICK TIP:**

Cut a little hole into parts 12 and 17 to be capable of pressing against the inside of parts 13 and 18 when you attach the greeblies. So you achieve a proper hold and prevent the caps from collapsing if too much pressure is applied.

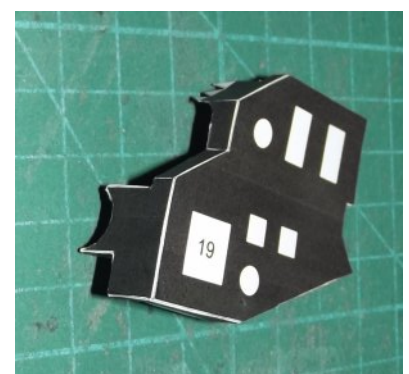
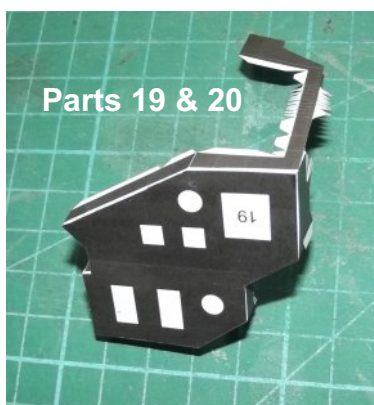



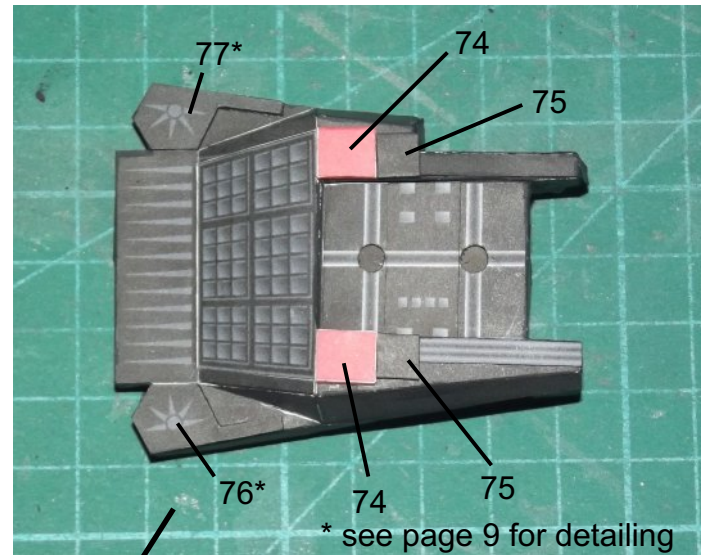
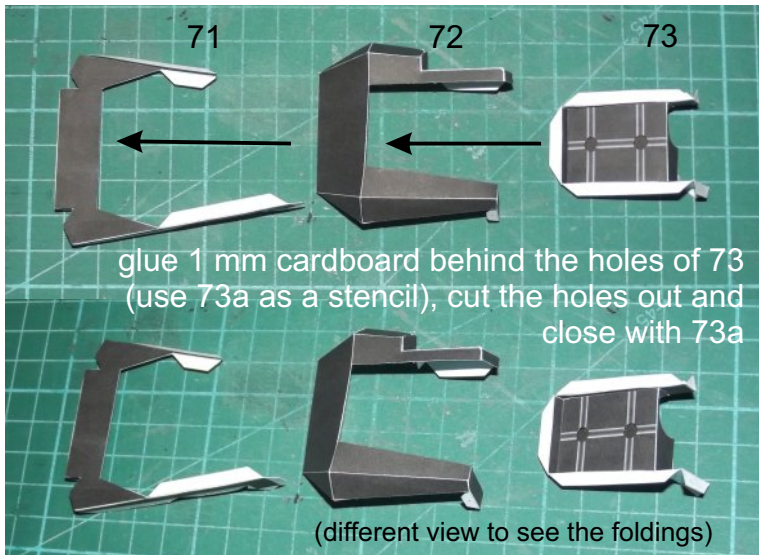
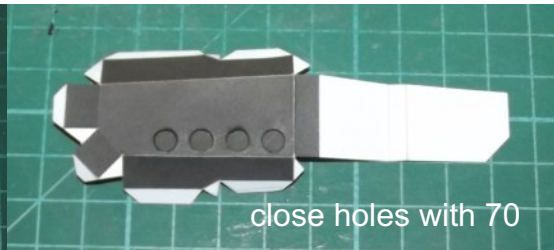
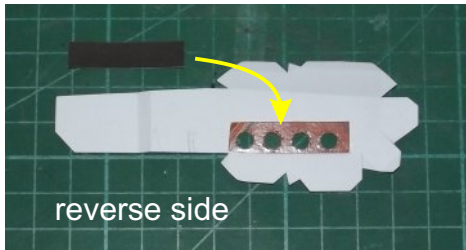
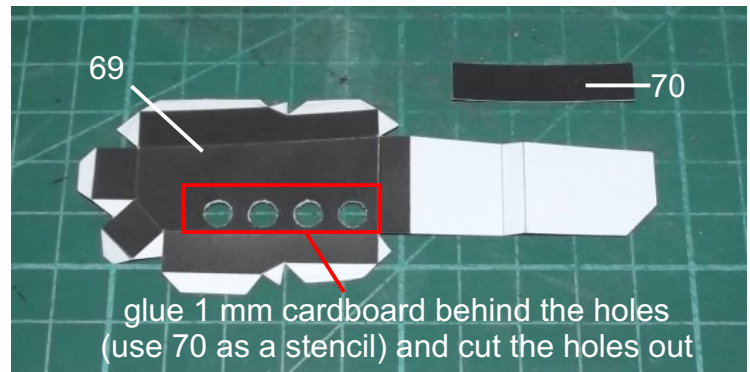
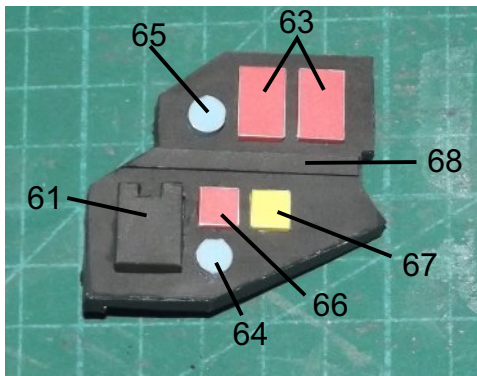

cut the part to shape  
if necessary to make it fit

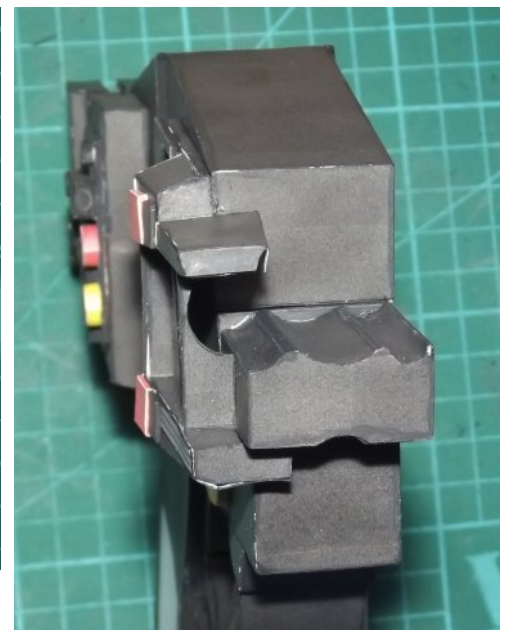
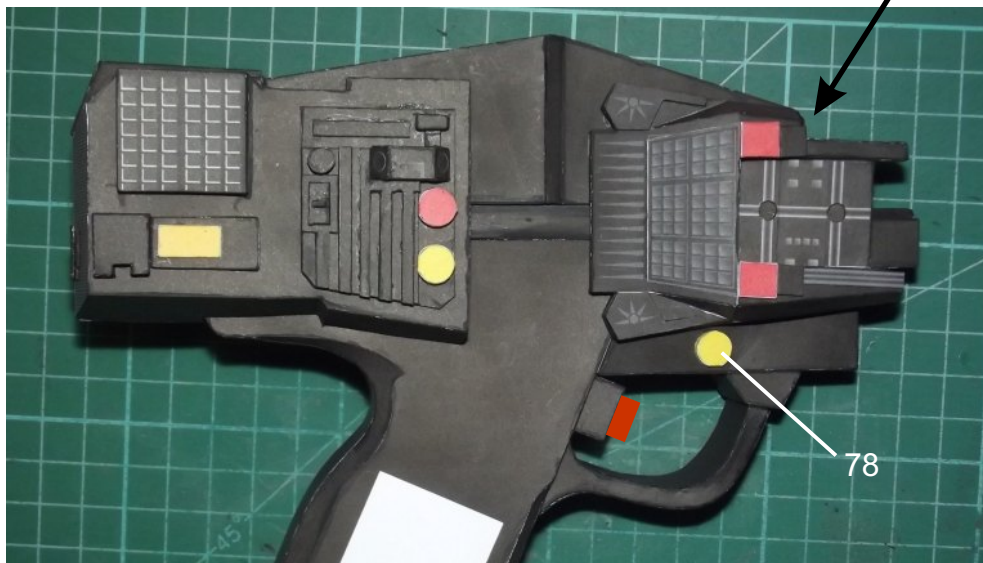



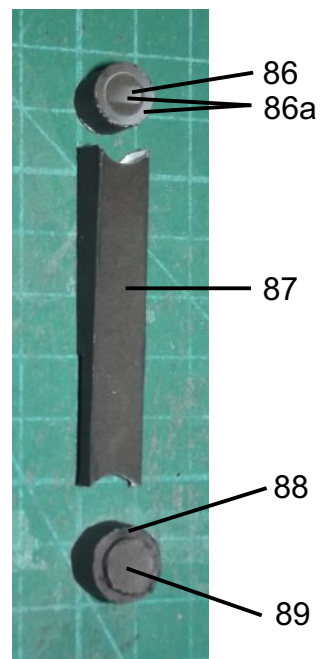
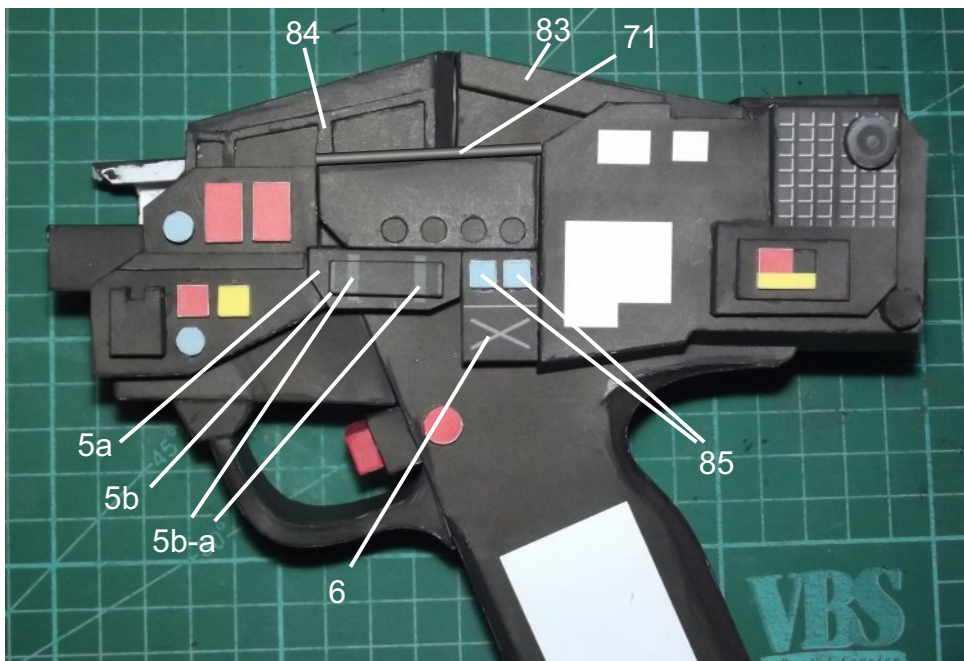
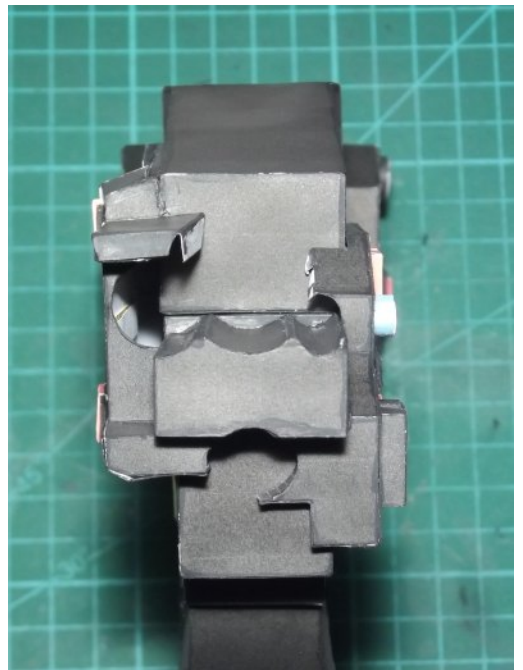
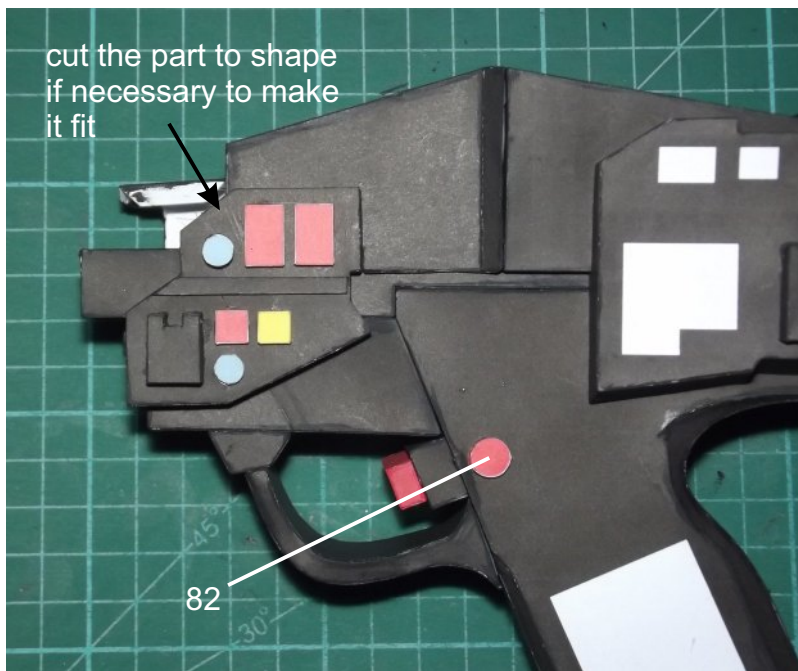
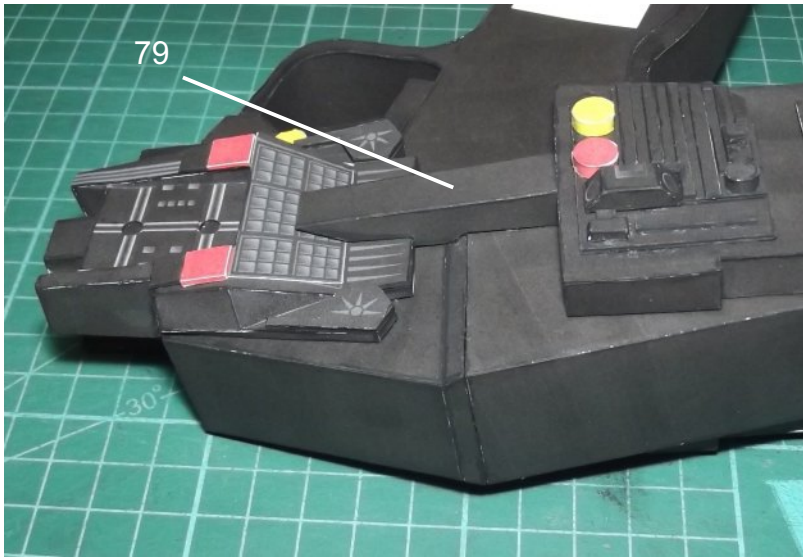



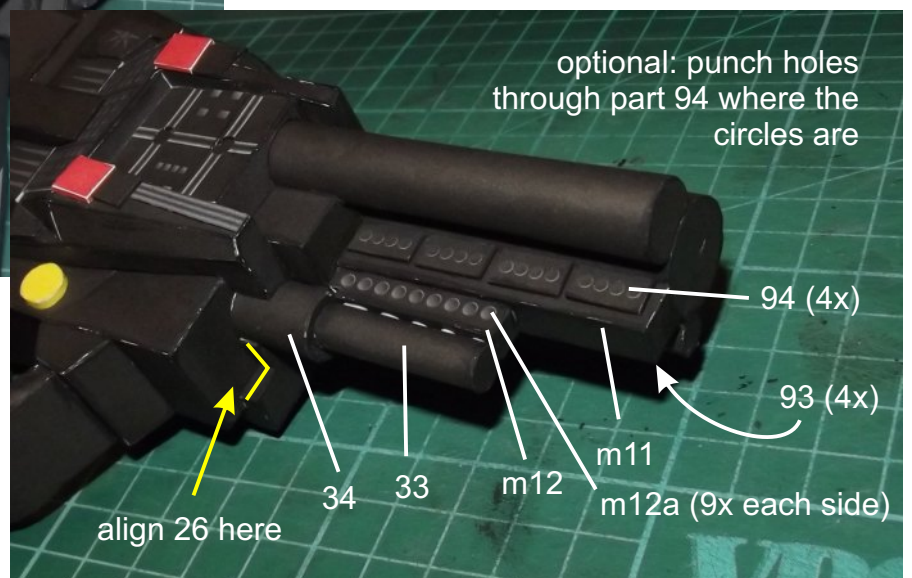
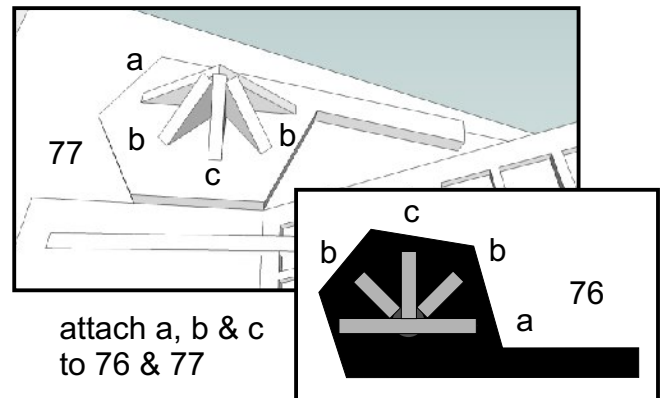
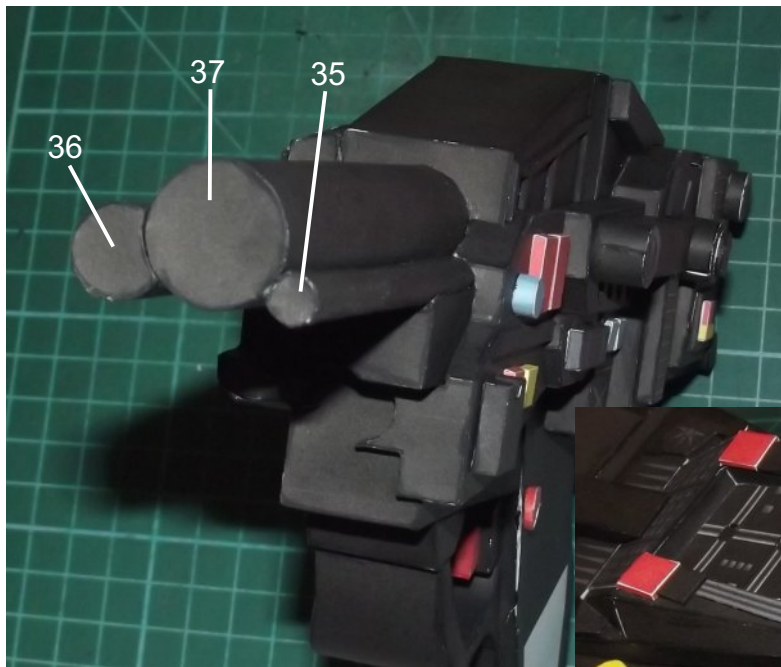
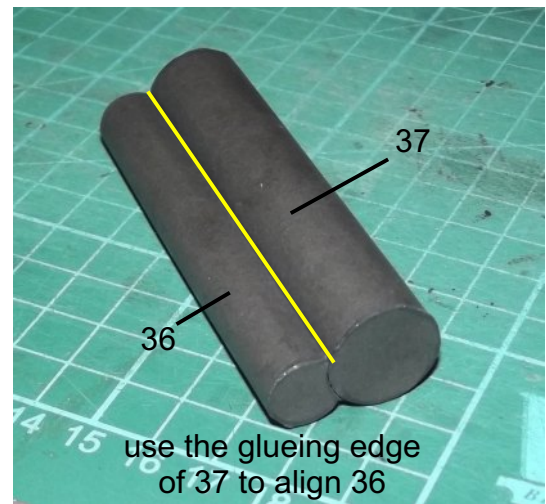
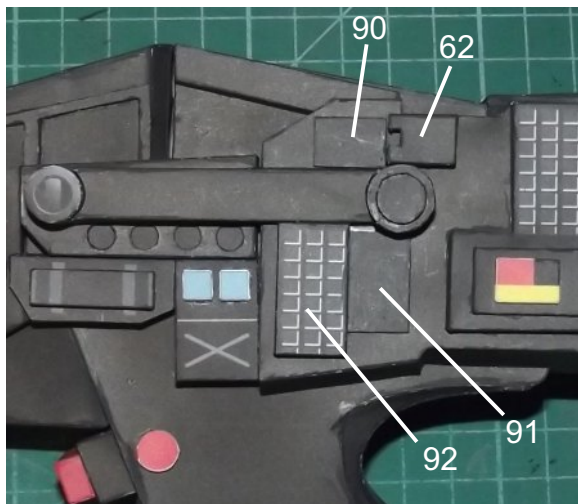
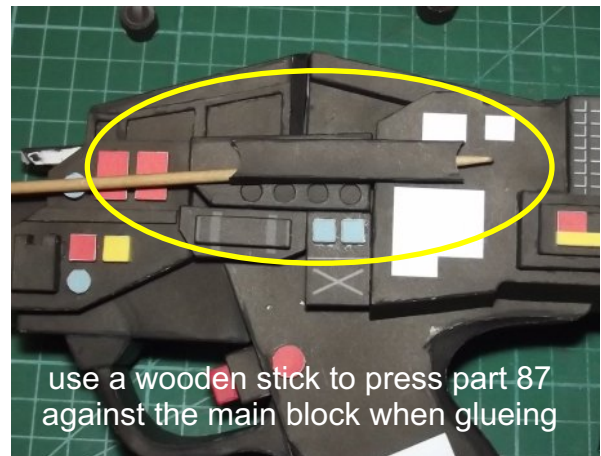
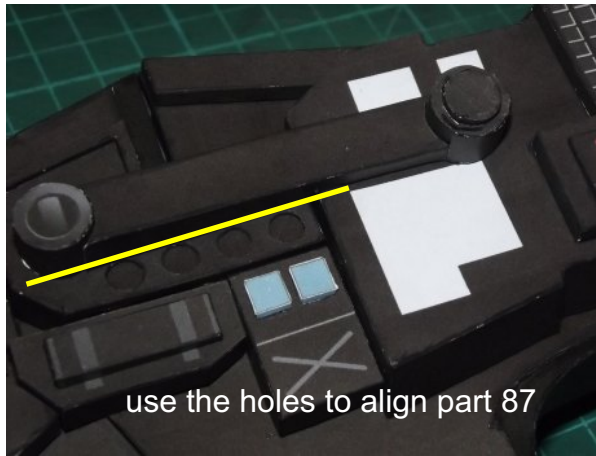



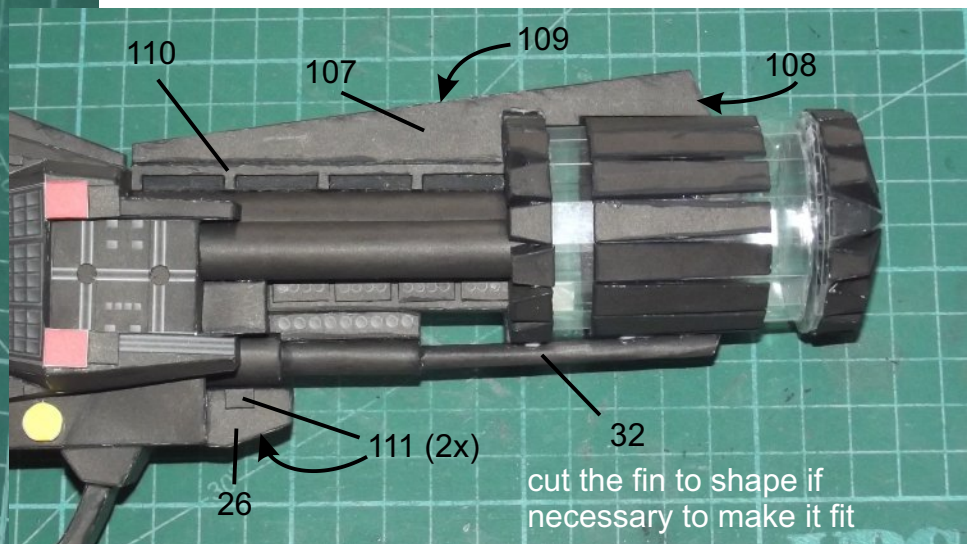
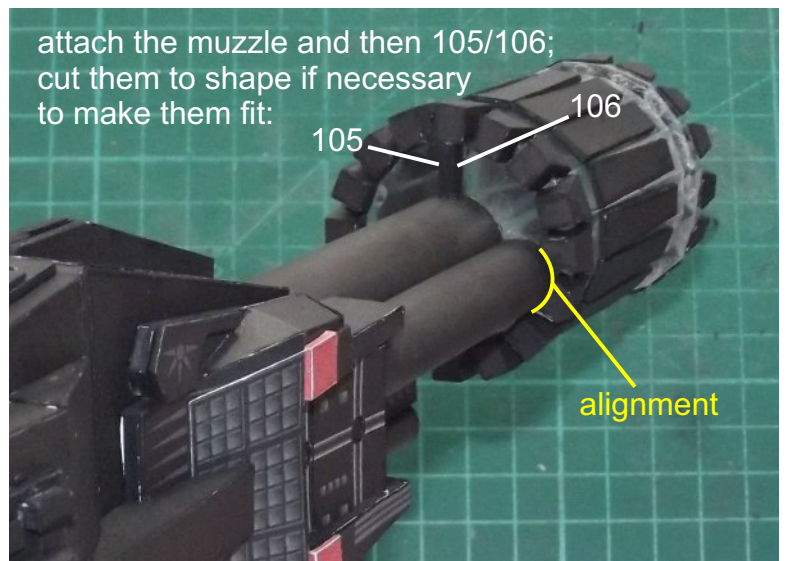
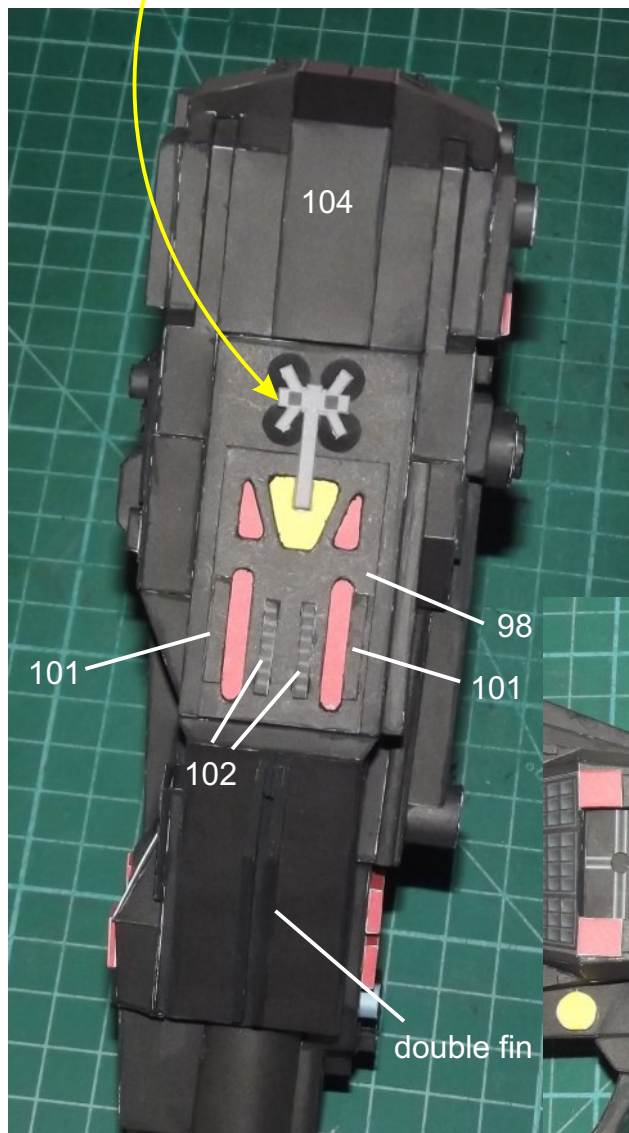
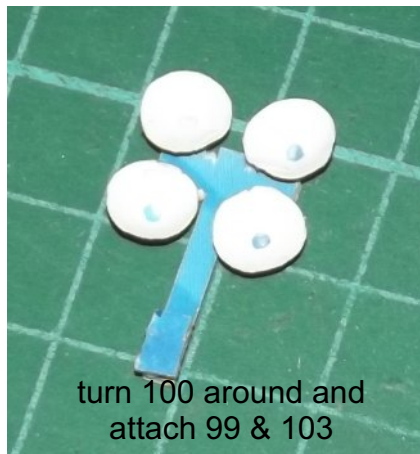
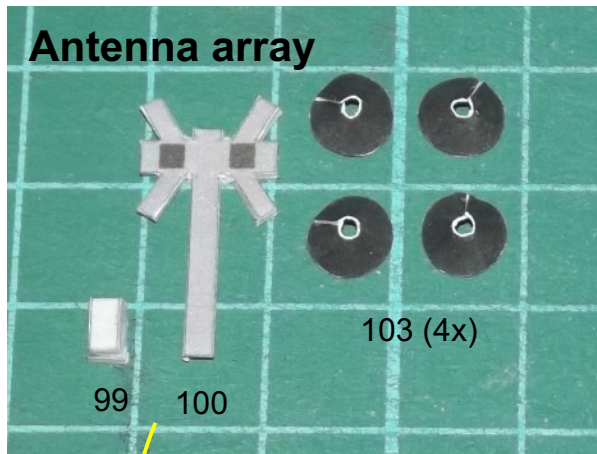
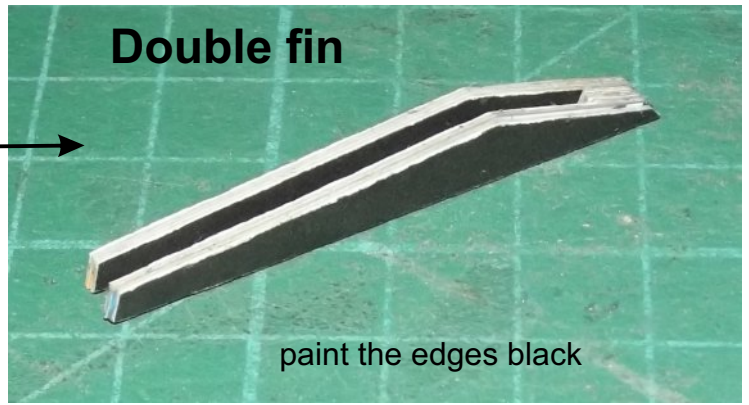
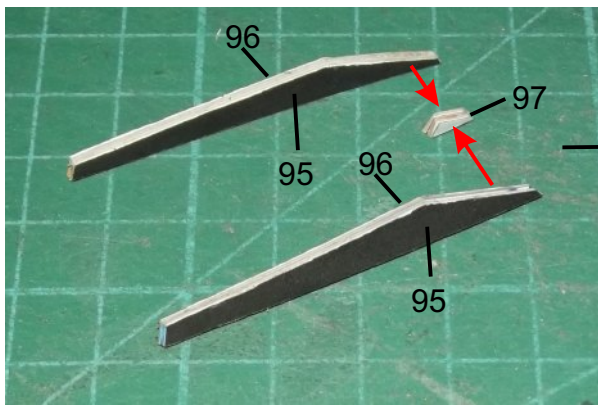



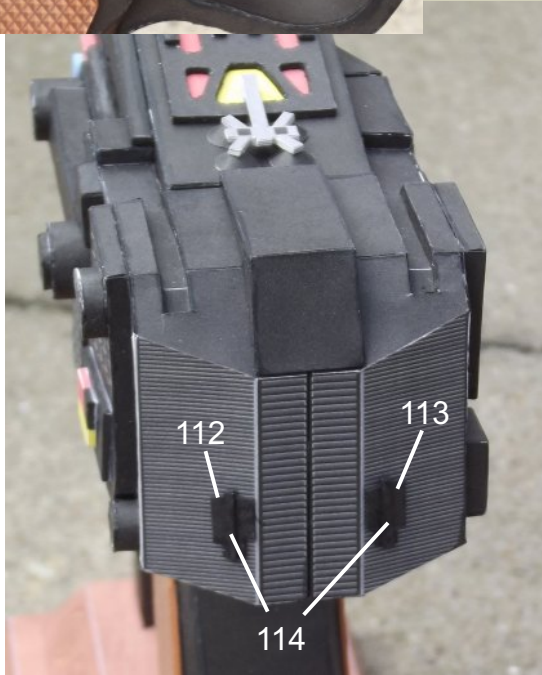
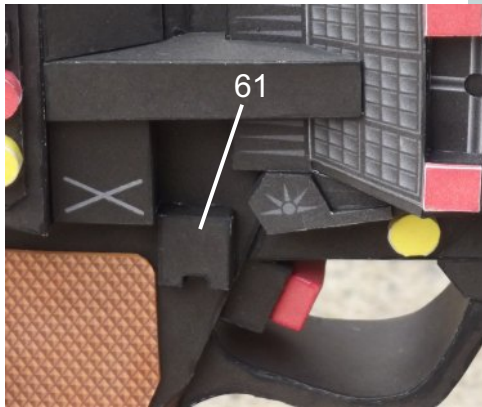

## Display stand

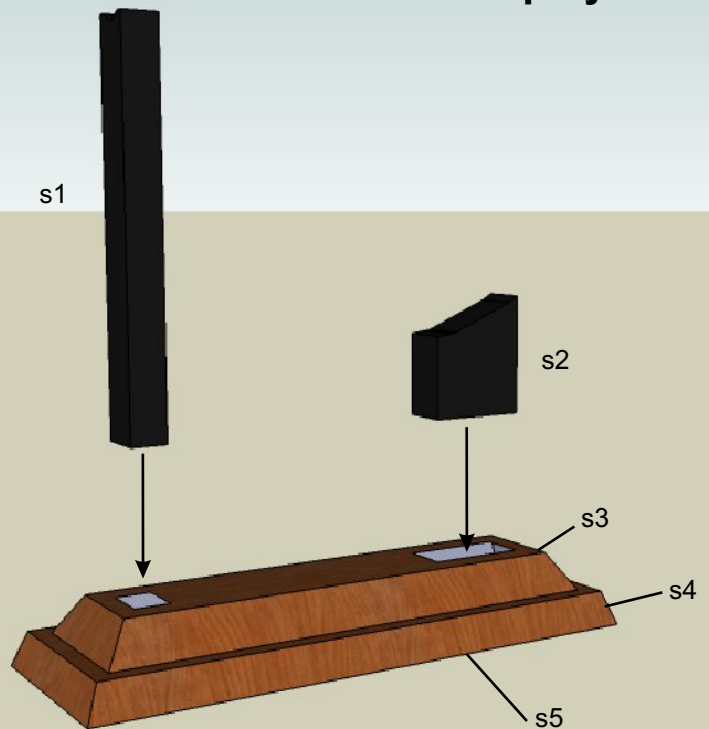







## Lit version

You can modify the model so that the muzzle flashes when the trigger is pulled. All you have to do is to make the trigger part 27 slide back and forth within part 26 and to put a blue ultra-bright LED into the center of part 37. If you would like to add a firing sound you can hide a sound module somewhere inside the rear caps. Everything would be powered by some batteries which are hidden inside the handle.

### 1. Moving trigger:

Laminate 29a to 1 or 2 mm cardboard. Glue 29 to 29a. Cut out the white rectangle in the middle of 28 and put 29 through the hole. Then combine 29a with a press button mounted inside 28 or the handle.

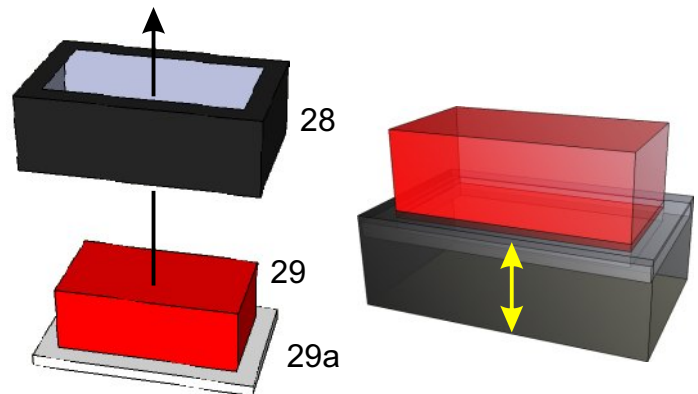

### 2. Battery case:

Choose a side from which to access the batteries (left OR right side of handle) and cut out the white rectangle marked with an "I" on that side. Leave the glue tabs and the other side of the handle intact. Cut out 31a (box) and 31b (cover). Glue 31a into the open rectangle of 21. Insert 31b and glue 38 (or 39) to 31b (not to 21!).

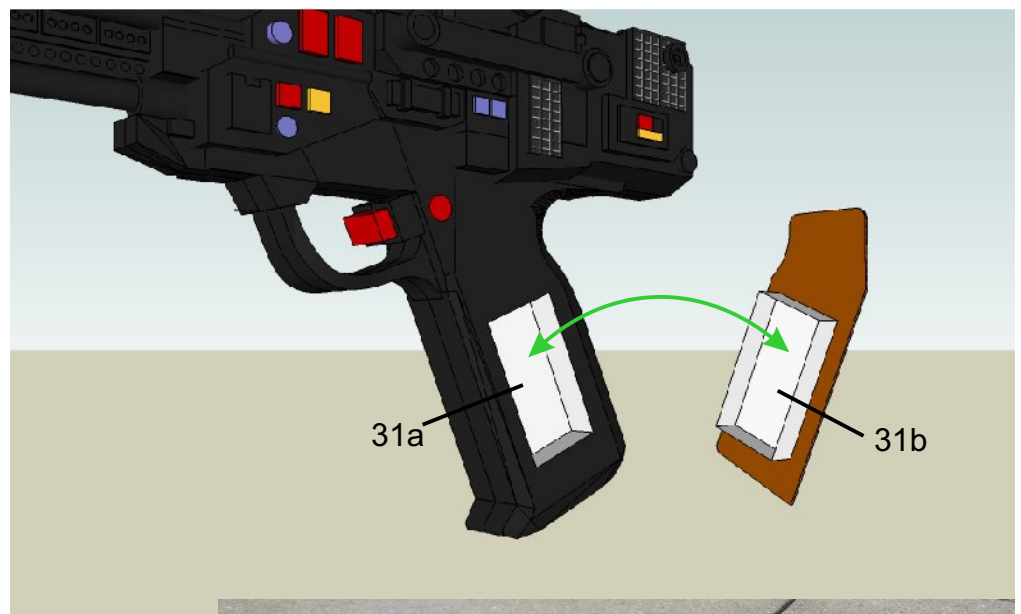

### 3. LED and sound module:

Insert an ultra-bright blue LED on top of 37 and inside the muzzle and glue reflective foil to the inside of m3a. The wires must not touch the foil to prevent a short circuit. Hide a sound module inside a rear cap and cut some tiny holes into 40 or 57 for better sound quality. Then connect everything with copper wire. When working with a soldering iron be very careful and **DO NOT HURT YOURSELF!**

